

PARTS & FUNCTION

Chime

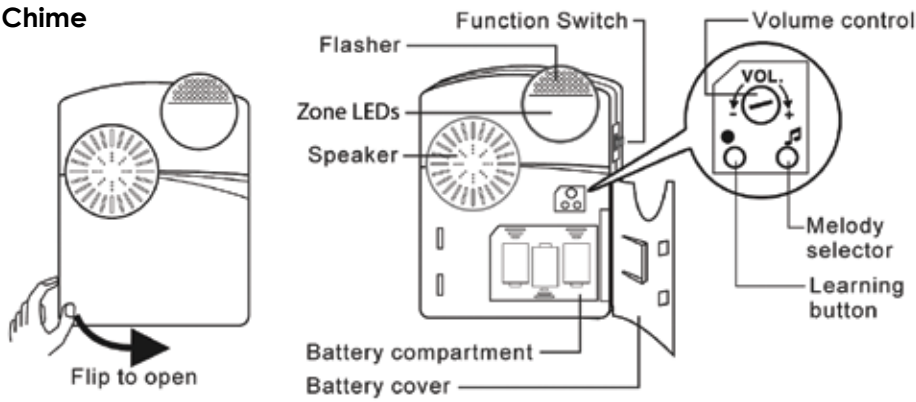

Remote Button

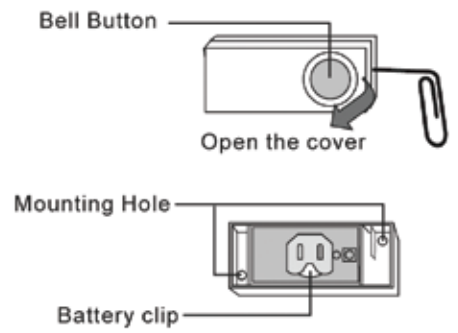

MOUNTING

Chime

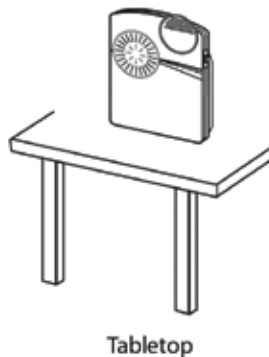
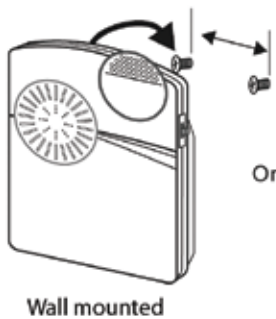

Remote Button

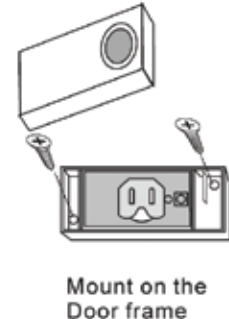

POWER

Chime

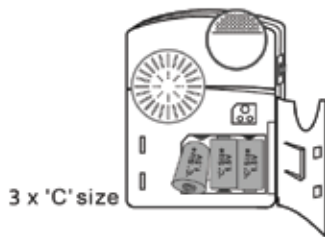

Remote Button



CODE MATCHING & TUNE SELECTION

Entering learning mode

Press and hold the "Learning" button 3 seconds. The LED #1 will flash. Press the "Learning" button again to select the zone you want to code. Then press the "Melody" button to select one of 16 melodies.

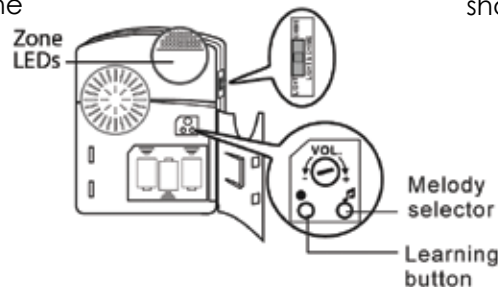

After selecting the zone and melody, press the remote button once (the remote button must be within 3 feet of the chime when programming.) If the coding is successful, the chime will generate a short tone.

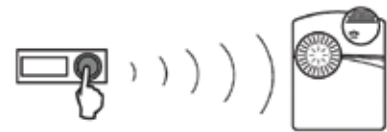

If another LED lights up, this remote button is already programmed on the zone that lights up.

DELETE THE REMOTE BUTTON ON THE CHIME MEMORY

First, press and hold the "Learning" button 3 seconds to enter the learning mode. Press the "Learning" button to select the zone you want to delete. Press and hold both the "Learning" and the "Melody" buttons 3 seconds. The chime will generate a tone to indicate the remote on this ID has been deleted.

Change the melody on desired zone

First, press and hold the "Learning" button 3 seconds to enter the learning mode. Press the "Learning" button to select the ID you want to change. Press the "Melody" button to select the new melody.

Dakota Alert
DC-1000



8 91179 00044 7

Made in China